

SWISSPEARL® FIBER CEMENT RAINSCREEN

Golisano Children's Hospital

Award-winning Children's Hospital with Swisspearl® Facade



[Ballinger's](#) primary focus of every design element was on the experience of the pediatric patient for the [Golisano Children's Hospital](#). A standalone pediatric facility as well as an integral part of the existing Strong Memorial Hospital, the eight-story building supports the hospital's mission to provide state-of-the-art care. [Swisspearl®](#) panels created a warmth, design and beauty the architect team wanted for this award winning building, paired with [ECO Cladding's Alpha Hci.10](#) Exposed Fastened System.

System Type: Alpha Hci.10 System
 Panel Type: Swisspearl® / Auria C-3552
 Architect: Ballinger

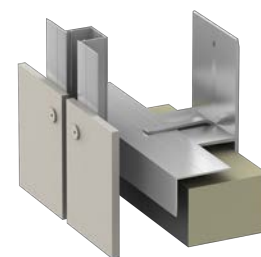

888-826-8453

CLADDING CORP

THE 1ST NAME IN RAINSCREEN